

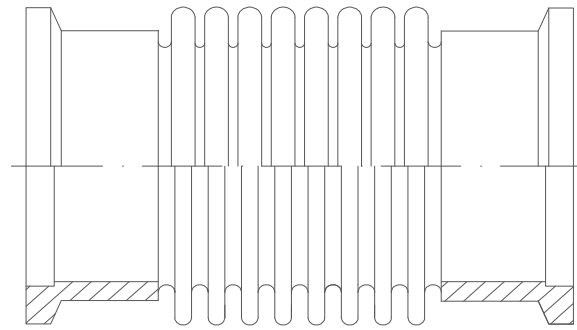

ISO-K Wellbälge

Vakuum



AN

PN 1
Vakuum
F / F

DN 16 - DN 50

Ausgabe 03/2017

| Nennweite | Bewegungsaufnahme (±50%) 1) | | Typ Bestellbez. des Herstellers | Bau- länge (± 3%) | KF-Flansch 4) | Metallbalg 3) | | | Feder- rate (± 30 %) | Gewicht gesamt (± 5%) |
|-------------|--------------------------------|---------------------|---------------------------------------|-------------------------|------------------|------------------|-------------------|--------------------------|----------------------------|-----------------------------|
| | axial > 10.000 LW | lateral 1.000 LW | | | | Innen- Ø | Außen- Ø | wirksamer Querschnitt | | |
| NB | movement (±50%) | | type | overall length | ISO-K flange | bellow inside | bellow outside | effective area | spring rate | weight |
| DN | axial | lateral | - | BL | | d _i | d _a | A | C _{ax.} | - |
| mm / inch | mm | mm | - | mm | | mm | mm | cm ² | N/mm | kg |
| 16 / 3/8" | 7 | 5 | AN 16 / 1 / a 13 / F / F | 60 | ISO-KF DN16 | 17 | 27,3 | 3,9 | 19 | 0,1 |
| 16 / 3/8" | 10 | 8 | AN 16 / 1 / a 18 / F / F | 70 | ISO-KF DN16 | 17 | 27,3 | 3,9 | 14 | 0,1 |
| 16 / 3/8" | 19 | 20 | AN 16 / 1 / a 31 / F / F | 100 | ISO-KF DN16 | 17 | 27,3 | 3,9 | 8 | 0,1 |
| 16 / 3/8" | 22 | 46 | AN 16 / 1 / a 40 / F / F | 120 | ISO-KF DN16 | 17 | 27,3 | 3,9 | 6 | 0,2 |
| 25 / 1" | 10 | 4 | AN 25 / 1 / a 21 / F / F | 60 | ISO-KF DN25 | 27 | 39,5 | 8,7 | 12 | 0,1 |
| 25 / 1" | 20 | 18 | AN 25 / 1 / a 31 / F / F | 80 | ISO-KF DN25 | 27 | 39,5 | 8,7 | 8 | 0,15 |
| 25 / 1" | 25 | 26 | AN 25 / 1 / a 50 / F / F | 100 | ISO-KF DN25 | 27 | 39,5 | 8,7 | 5 | 0,2 |
| 25 / 1" | 32 | 44 | AN 25 / 1 / a 63 / F / F | 120 | ISO-KF DN25 | 27 | 39,5 | 8,7 | 4 | 0,2 |
| 40 / 1 1/2" | 11 | 3 | AN 32 / 1 / a 19 / F / F | 60 | ISO-KF DN40 | 39 | 56 | 17,7 | 7 | 0,2 |
| 40 / 1 1/2" | 28 | 22 | AN 32 / 1 / a 41 / F / F | 100 | ISO-KF DN40 | 39 | 56 | 17,7 | 8 | 0,35 |
| 40 / 1 1/2" | 36 | 3,2 | AN 32 / 1 / a 53 / F / F | 120 | ISO-KF DN40 | 39 | 56 | 17,7 | 20 | 0,4 |
| 50 / 2" | 13 | 3 | AN 50 / 1 / a 20 / F / F | 60 | ISO-KF DN50 | 51,4 | 76 | 32 | 24 | 0,5 |
| 50 / 2" | 30 | 14 | AN 50 / 1 / a 49 / F / F | 100 | ISO-KF DN50 | 51,4 | 76 | 32 | 8 | 0,8 |
| 50 / 2" | 39 | 38 | AN 50 / 1 / a 64 / F / F | 120 | ISO-KF DN50 | 51,4 | 76 | 32 | 7 | 1,0 |

The team from Flexomat GmbH is at your disposal at all times to answer any questions!

Contact us

1) - Bewegungen nicht gleichzeitig, andere Bewegungen und Baulängen auf Anfrage
no several movements at a time; additional movements and building length by request
2) - Werkstoff Wellbalg 1.4571 / Werkstoff Flansch 1.4301; andere Werkstoffe auf Anfrage
material bellows 1.4571 / material flange 1.4301; additional materials by request
3) - inkl. He-Lecktest, mit Verschlußkappen und in Folie verschweißt
incl. vacuum test, with caps and packed in foil

FLEXOMAT GmbH
Lindigtstraße 2
Gewerbegebiet Heynitz-Lehden
01683 Nossen

Tel.: (035242) 4394 - 100
Fax: (035242) 4394 - 140
E-Mail: service@flexomat.de
Web: www.flexomat.de/shop/en

